





**MEM Bath spout for wall mounting - Brushed Durabron (23kt Gold)**

MEM

13 801 782

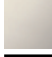

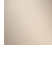
- 220mm projection
- rectangular, air-enriched flow
- rosette 60 x 60 mm
- hole diameter 37 mm
- 1/2" connection
- max. flow 38.5 l/min at 3 bar flow pressure
- WRAS 2203039

	Brushed Durabron (23kt Gold)	13 801 782-28
	Chrome	13 801 782-00
	Brushed Platinum	13 801 782-06
	Platinum	13 801 782-08
	Dark Chrome	13 801 782-19
	Brushed Champagne (22kt Gold)	13 801 782-46
	Champagne (22kt Gold)	13 801 782-47
	Brushed Dark Platinum	13 801 782-99

**Required miscellaneous**

**Concealed adapter -**

35 080 970-90  
0010



13 801 782

mm [inches]

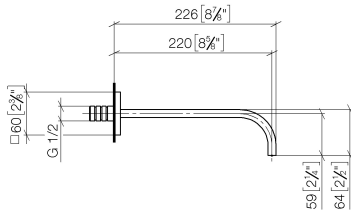

**Flow rate chart**

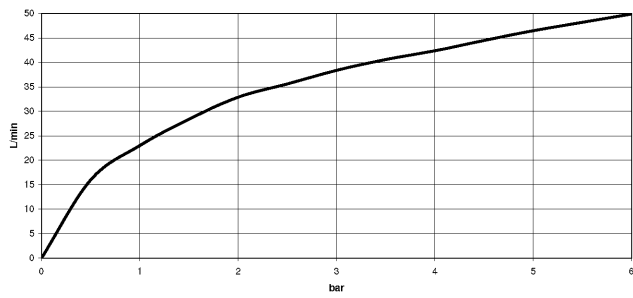

**Codes & Standards**

ASME  
A112.18.1/CSA  
B125.1



MEM Bath spout for wall mounting - Brushed Durabronz (23kt Gold)

---

MEM

13 801 782

Certificates

---

WRAS\_2203039.

13 801 782

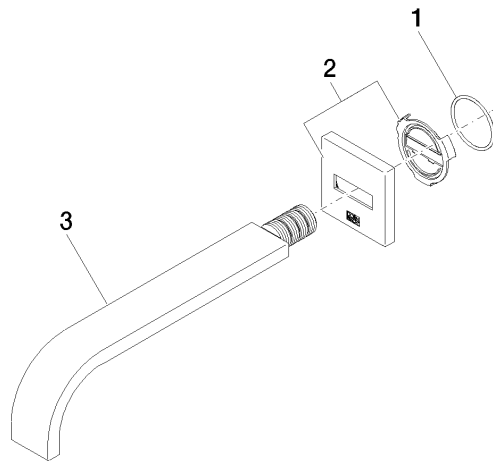

### Spare parts list

No.	Item Number	Name	Quantity used	Delivery time
1	09 14 10 111 90	seal	1	2
2	90 27 78 035 00-28	rosette	1	20
3	04 28 22 290 00-28	spout	1	20